



Wright-Locke Farm: A Thriving Community-Centered Farm with a Unique Opportunity

Wright-Locke Farm

- ▶ A working farm, rich with history (est. 1638) and open to the public
- ▶ One of the *last* farms within the arc of Route 128
- ▶ A strong community presence with our education programs, public events, and volunteer engagement
- ▶ Unique outdoor and farm-based opportunities to thousands of children each year

- ▶ Unprecedented local support -- in 2015 we raised \$8.6 million to purchase the surrounding land to protect it from being developed

In the last nine years, our dedicated staff and **hundreds of committed volunteers** have transformed Wright-Locke into a **center of learning and exploration** surrounding topics of sustainable agriculture, nutrition, the environment, and community health. With our strong collaborative energy, we strive to broaden and deepen our community impact.

Community Engagement in 2016

100s

enjoy our landscape & trails weekly

6,000

community members came to our free concert series

1,754

children learned about farming and nature

\$80,000

of organic produce sold to our community

33

adult workshops hosted

However...

- ⚠ We are limited by the constraints of our facilities
- ⚠ Our events and education programs are at full capacity in terms of facilities and staff
- ⚠ We lack heated indoor space, so our operations cease in the wintertime
- ⚠ Demands on our staff are high; we need the resources to employ full-time, year-round staff to accommodate the growing interest in our farm
- ⚠ We rely on donations for the maintenance of our irreplaceable historic buildings



To ensure the future of the farm and to facilitate the growing energy behind Wright-Locke, we are undertaking a bold initiative to construct a new **Education Center**.



THE EDUCATION CENTER
AT
WRIGHT-LOCKE
FARM WINCHESTER, MA

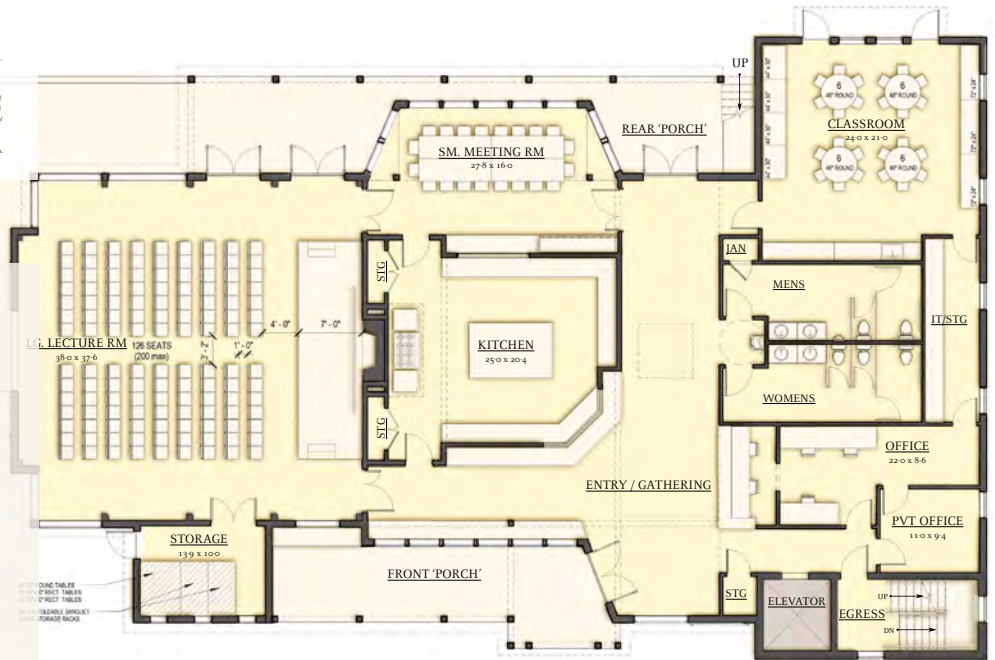

GROUND LEVEL FLOOR PLAN

Our plan is ambitious:

We envision a sensitively designed building that would be situated on the site of the vacant yellow house (82 Ridge Street) and would have a footprint of 5,400 square feet.

The Education Center would include:



Classroom space for 20 children



A commercial "Innovation Kitchen" for cooking and nutrition education, meal prep, and product development



Event/lecture space for up to 200 people

The Education Center will...



Educate

Expand our educational impact by extending our season, class and staff capacity, as well as broadening our educational offerings and ability to reach underserved populations



Nourish

Strengthen the link between food and health with an Innovation Kitchen

Photo courtesy of our friends at Powisset Farm



Connect

Expand our ability to facilitate and inspire in Winchester and beyond by connecting with a broader range of people and organizations, including the vibrant academic institutions of Greater Boston



Sustain

Stabilize our financial model by providing a springboard for continued growth, increasing top-line revenues by 60%, and enabling investment in professional staff

Impact of the New Education Center

80 → 127

Youth Education Programs (+47 programs)

1,754 → 2,450

Children Impacted by Education Programs (+696 children)

33 → 69

Adult Educational Workshops (+36 workshops)

530 → 962

Adult Workshop Attendees (+432 adults)